

## FLAT D2 | 3B 2T

Available in Tower A

Wall hanging  
Wardrobe Space  
in each room  
for maximum  
utilization of  
space

A Multipurpose  
Double Height  
Open Terrace  
for your comfort

Cross  
ventilated  
Bedroom  
for fresh air  
and light

Glass window  
beside the  
Open Terrace  
for more light  
in the Living  
Dining room

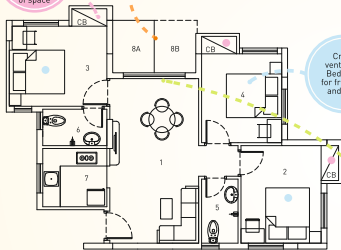

|    |               |   |
|----|---------------|---|
| 1  | Living/Dining | 10'0" x 18'6"                           |
| 2  | Bedroom       | 11'0" x 11'0" [11'0" x 9'0" without CB] |
| 3  | Bedroom       | 11'0" x 11'0" [11'0" x 9'0" without CB] |
| 4  | Bedroom       | 12'0" x 9'0" [10'0" x 9'0" without CB]  |
| 5  | Toilet        | 7'3" x 4'1"                             |
| 6  | Toilet        | 7'3" x 4'1"                             |
| 7  | Kitchen       | 7'3" x 6'7"                             |
| 8A | Open terrace  | 4'8" x 5'11"                            |
| 8B | Open terrace  | 4'8" x 5'11"                            |

Carpet area 640 sq.ft.

Built up area 745 sq.ft.

Standard built up area 1050 sq.ft.